

**ONE**<sup>®</sup>  
**FOR ALL**

# UNIVERSAL FLAT WALL MOUNT

QUICK INSTALLATION GUIDE  
GUIDE D'INSTALLATION RAPIDE

**WM6812**



ONE FOR ALL  
**ASSISTANT APP**





Universal

- 200 x 200 | 200 x 300 | 300 x 300 | 300 x 400
- 400 x 200 | 400 x 300 | 400 x 400 | 600 x 400
- 600 x 600 | 800 x 400 | 800 x 600 | 800 x 800
- 850 x 400 | 900 x 600

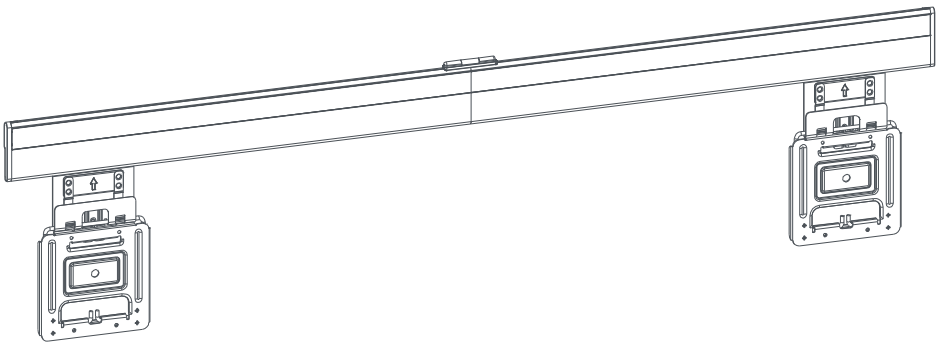
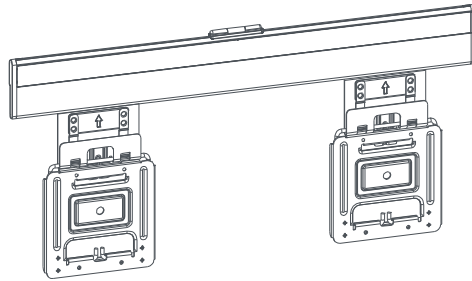



**A**



**B**



**C**

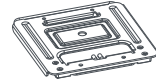

**D** 2 x

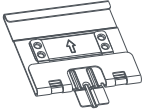

**E** 2 x



**F**



**G**



**H** 2 x



**I**



**J**



**K**



**L** 4 x



**M** 4 x



**N** 2 x

M5x5



**O**

3mm

## Package M

**M-A** 4 x M5x14mm



**M-B** 4 x M6x14mm



**M-C** 4 x M6x30mm



**M-D** 4 x M8x12mm

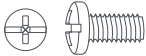

**M-E** 4 x M8x30mm

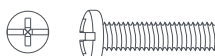

**M-F** 4 x M8x50mm

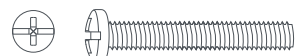

**M-G** 4 x D6mm



**M-H** 8 x  $\varnothing 15 \times \varnothing 8 \times 5 \text{mm}$



**M-I** 8 x  $\varnothing 15 \times \varnothing 8 \times 15 \text{mm}$



## Package W

**W-A** 4 x ST6.3x55mm



**W-B** 4 x  $\varnothing 10 \times 50 \text{mm}$



**W-C** 4 x D6mm



# START



## 1a-1

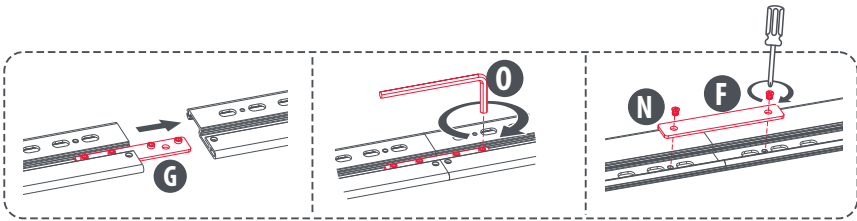
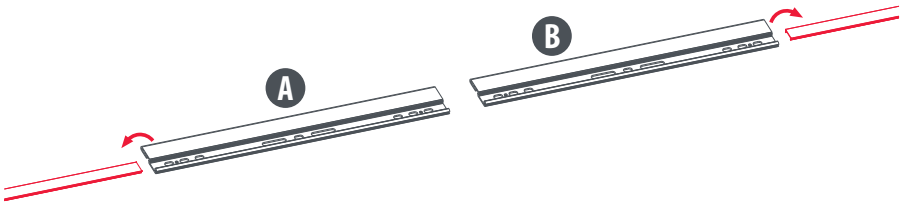

## 1a-2

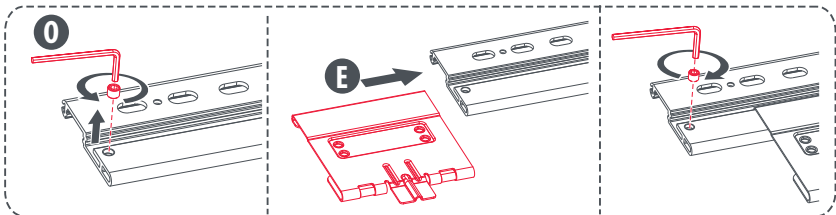
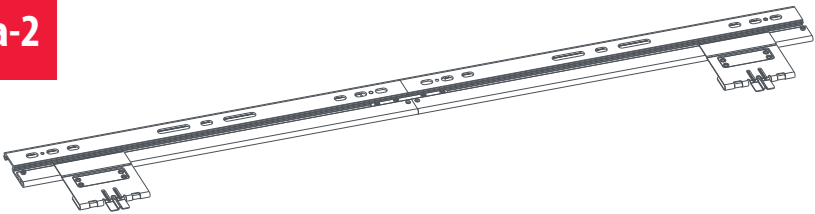

1a-3



# WARNING

Please verify that the supporting surface will safely support the combined weight of the equipment and all attached hardware and components

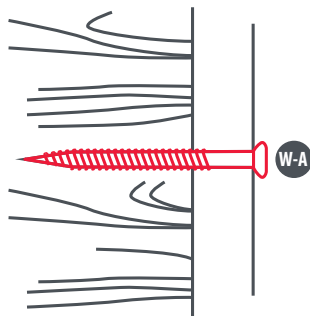
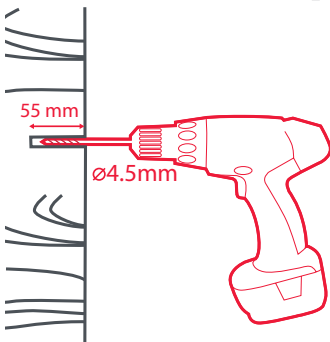
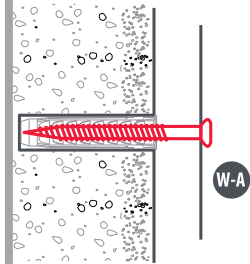
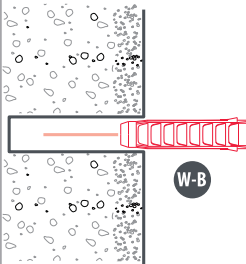
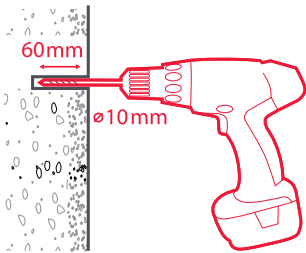
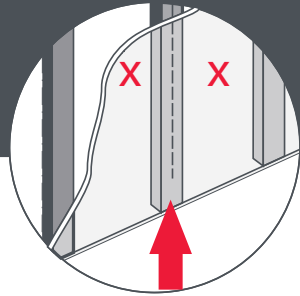

# 1a-4

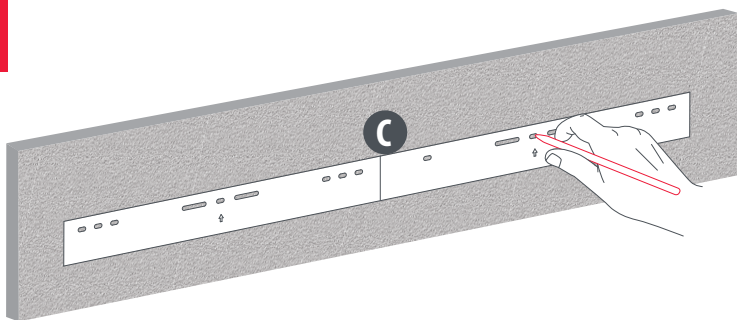

Note: Keep the drill guide level.

# 1a-5

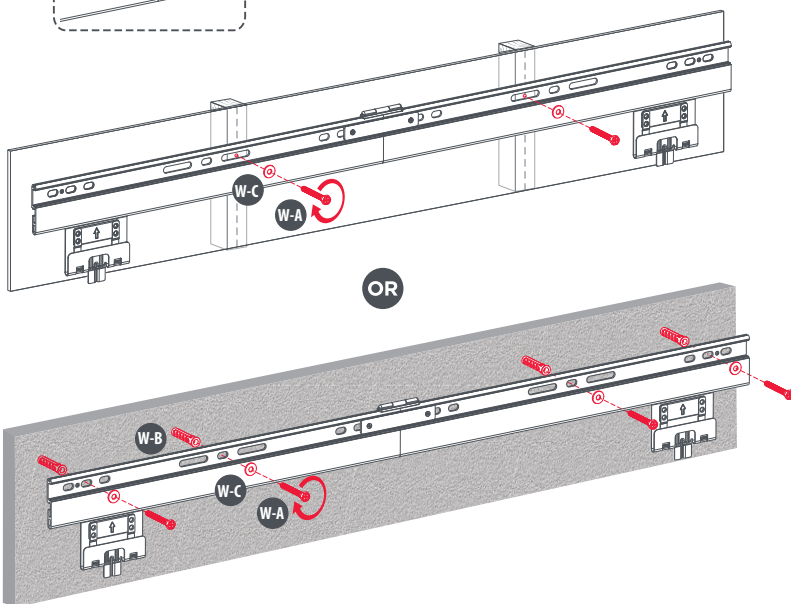
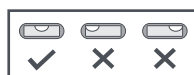
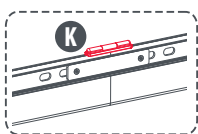

# 1a-6

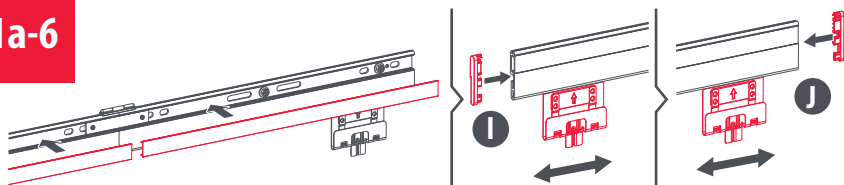

1b-1

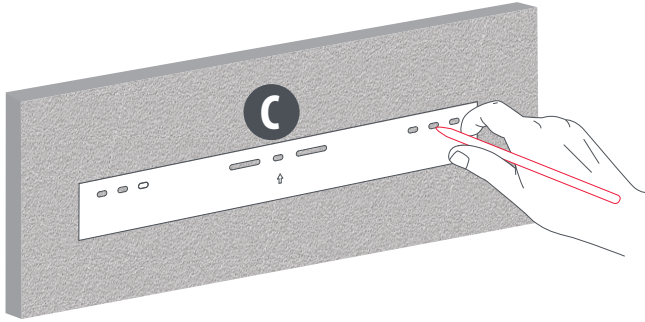

Note: Keep the drill guide level.

1b-2

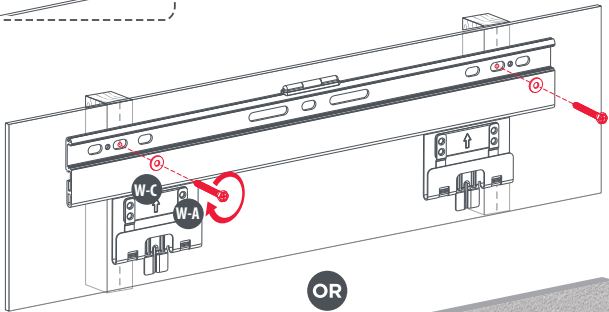
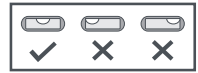
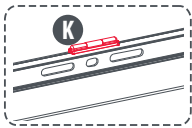

OR

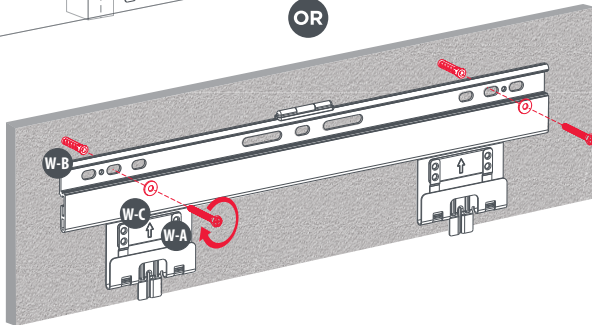

1b-3

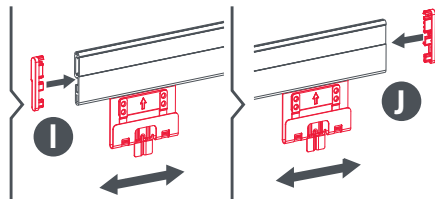
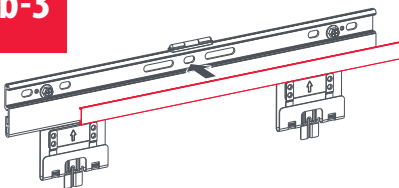

2

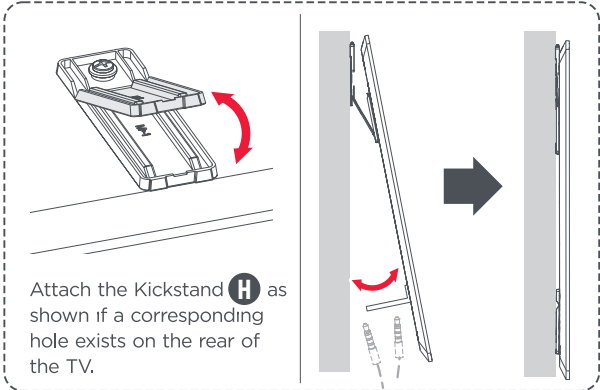
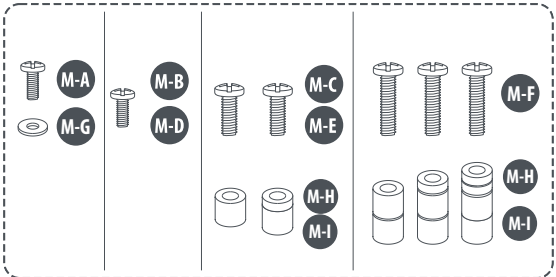
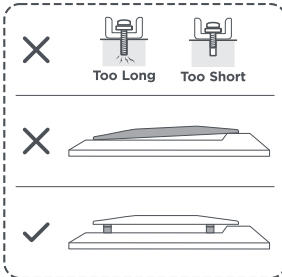
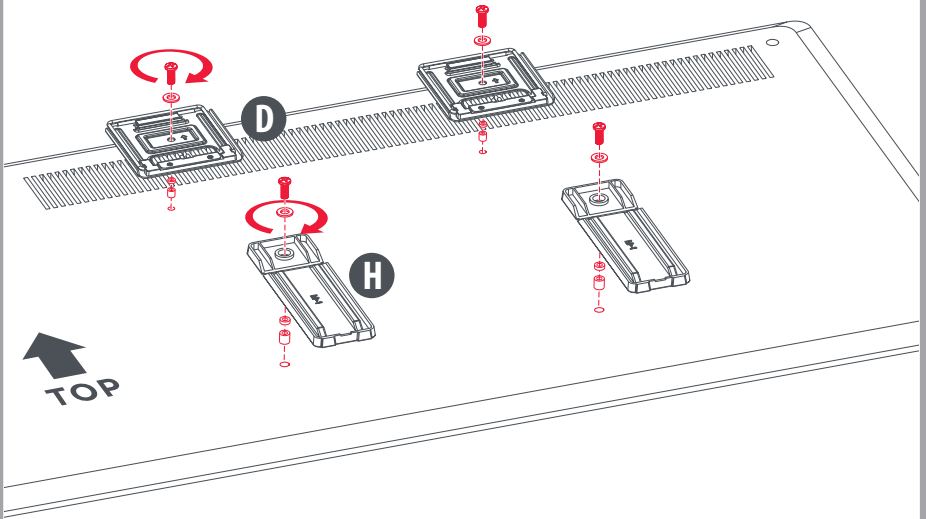
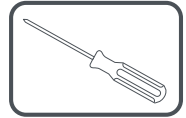

3

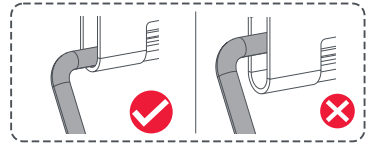
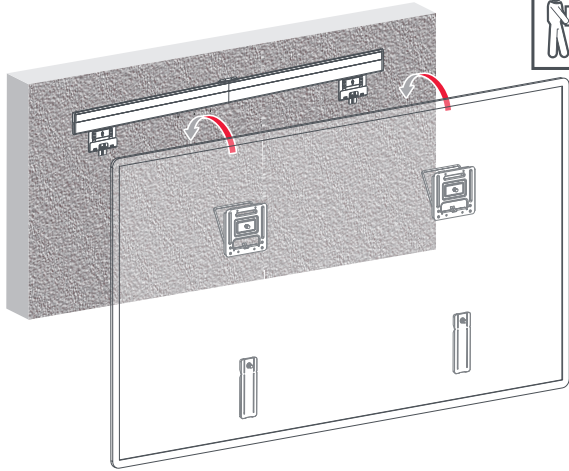
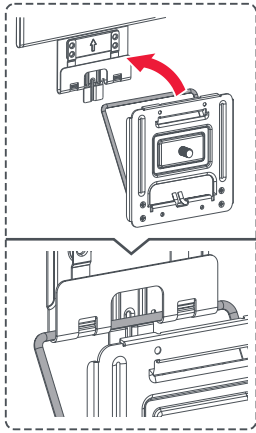

4

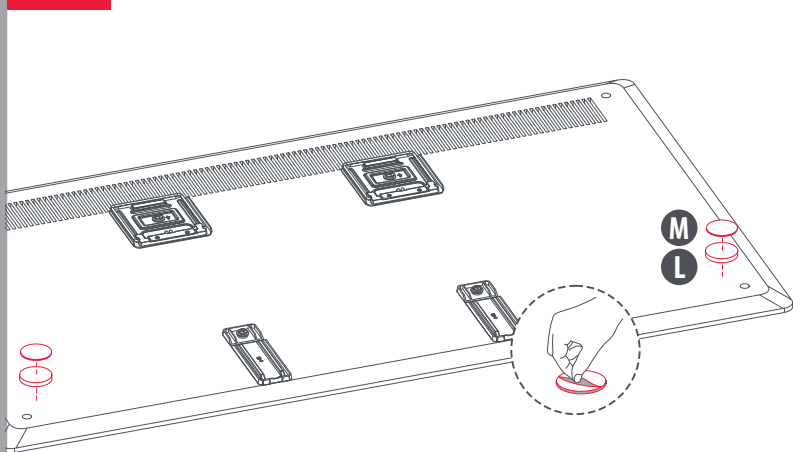

Attach appropriate EVA Pads **L** and **M** to the display to fill the wall-to-TV gap.

5

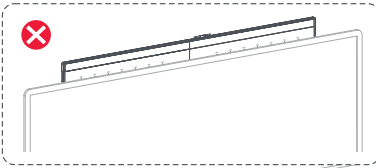

*Note: For TVs 55" and smaller, attach Panel **D** to the lower two VESA holes if the TV doesn't fully cover the wall plate.*

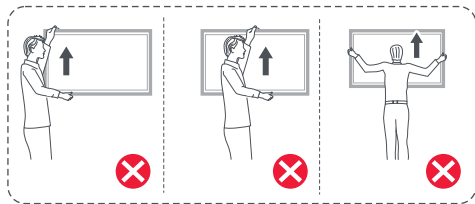
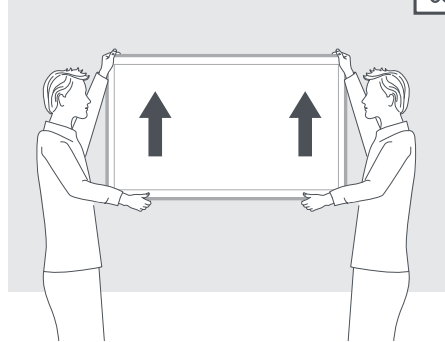
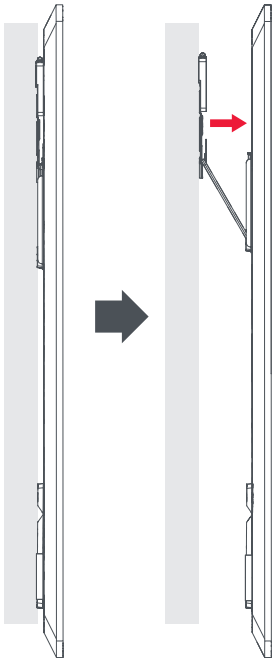
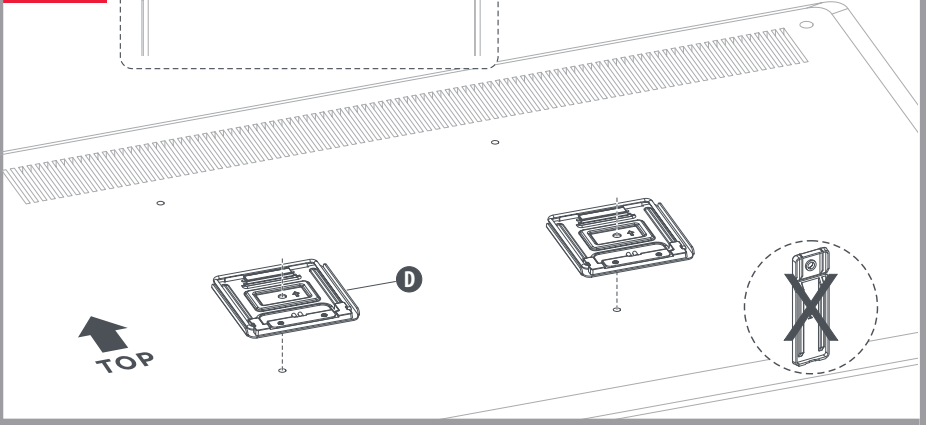

**FINISH**

**ENGLISH**

Thank you for purchasing this ONE FOR ALL product! The product you now have in your possession is made of durable materials and is based on a design, every detail of which has been meticulously thought out. That is why ONE FOR ALL gives you a Life Time guarantee for defects in materials or manufacturing.

**GUARANTEE TERMS AND CONDITIONS**

1. ONE FOR ALL guarantees that if during the guarantee period of a product, faults arise due to defects in manufacturing and/or materials, it will, at its discretion, repair or if necessary replace the product, free of cost. A guarantee for normal wear and tear is hereby expressly excluded.
2. If the guarantee is invoked, the product should be sent to ONE FOR ALL together with the original purchase document (invoice, sales slip or cash receipt). The purchase document should clearly show the name of the supplier and the date of purchase.
3. ONE FOR ALL guarantee shall lapse in the following cases: - If the product has not been drilled, installed and used in accordance with the Instructions for Use; - If the product has been altered or repaired by a party other than ONE FOR ALL; - If a fault arises due to external causes (outside the product) such as for example lightning, water nuisance, fire, scuffing, exposure to extreme temperatures, weather conditions, solvents or acids, wrong use or negligence; - If the product is used for different equipment than is mentioned on or in the packing.

**UNIVERSAL ELECTRONICS BV, COLOSSEUM 2, 7521 PT ENSCHEDE, THE NETHERLANDS****WARNING**

Correct installation is extremely essential, and falls outside the scope of responsibility of ONE FOR ALL. The fastening material provided is exclusively intended for installation on walls made of solid wood, bricks, concrete or solid-wood columns with a maximum of 3 mm wall finishing. For walls made of other materials, for example hollow bricks, please consult your installer and/or specialist supplier. During installation, please also follow the instructions for installation and use of the apparatus to be installed/fixe (for example the LCD/LED/plasma screen).

**FRANÇAIS**

Merci d'avoir fait l'acquisition de ce produit ONE FOR ALL ! Le produit que vous avez maintenant en votre possession est fabriqué avec des matériaux durables et sa conception a été pensée dans les moindres détails. C'est pourquoi ONE FOR ALL vous propose une garantie à vie contre tout vice de fabrication ou de matériaux.

**CONDITIONS GÉNÉRALES DE GARANTIE**

1. La société ONE FOR ALL vous garantit que, en cas de défaillance survenant durant la période de garantie du produit du fait d'un vice de fabrication et/ou d'un défaut de matériau, elle procédera gratuitement, à sa discrétion, à la réparation ou, si nécessaire, au remplacement du produit. Les problèmes dus à une usure normale du produit sont expressément exclus de la présente garantie.
2. Dans le cas où la garantie est invoquée, le produit doit être renvoyé à ONE FOR ALL accompagné de l'original de la preuve d'achat (facture, reçu de vente ou ticket de caisse). La preuve d'achat doit clairement indiquer le nom du revendeur et la date d'achat.
3. La garantie ONE FOR ALL sera considérée caduque dans les cas suivants: - Si le produit n'a pas été percé, installé et utilisé conformément aux instructions d'utilisation fournies; - Si le produit a été modifié ou réparé par un tiers autre que ONE FOR ALL; - Si un problème survient du fait d'une cause extérieure au produit, par exemple en cas de foudre, de dégât des eaux, d'incendie, d'éraflure, d'exposition à des températures extrêmes, aux conditions météorologiques, à des solvants ou acides, d'utilisation incorrecte ou de négligence; - Si le produit est utilisé pour un équipement différent de celui indiqué sur ou dans l'emballage.

**UNIVERSAL ELECTRONICS BV, COLOSSEUM 2, 7521 PT ENSCHEDE, PAYS-BAS****AVERTISSEMENT**

Une installation correcte est essentielle et n'est pas de la responsabilité de ONE FOR ALL. Les accessoires de fixation fournis sont exclusivement destinés à l'installation du produit sur des murs faits de bois massif, de briques pleines ou de béton, ou sur des colonnes en bois massif, avec un revêtement d'une épaisseur maximum de 3 mm. Pour les murs et cloisons fabriqués dans d'autres matériaux, par exemple des briques creuses, veuillez consulter votre installateur et/ou un spécialiste. Lors de l'installation, veuillez respecter les instructions d'installation et d'utilisation de l'appareil à installer/fixer (par exemple un écran LCD/LED/plasma).

WM6812  
713875  
RDN-1100225

Universal Electronics BV – Europe & International  
P.O. Box 3332, 7500 DH Enschede  
The Netherlands

Separate the waste  
Differenzia i Rifiuti



<http://www.oneforall.com/documents>