

Smart Control Pro Touch

ENGLISH

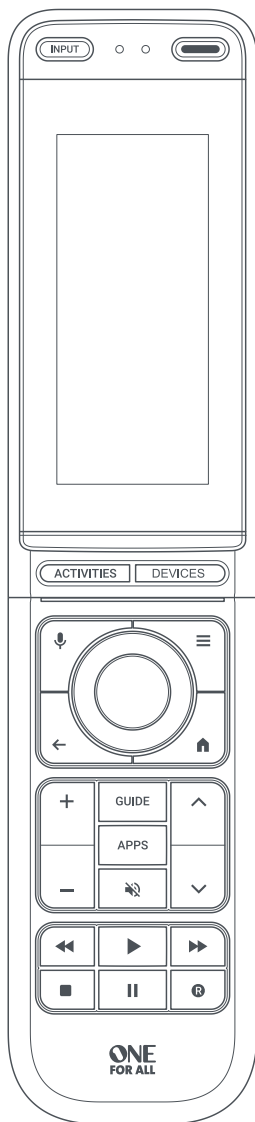

BATTERIES

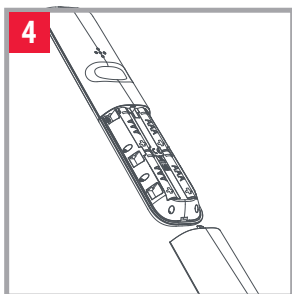
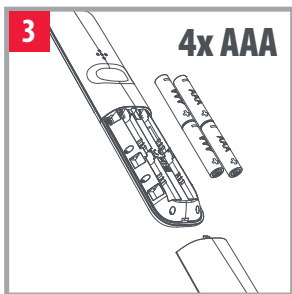
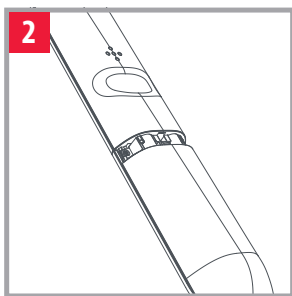
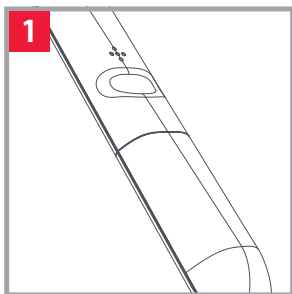

KEY DESCRIPTIONS | URC7985

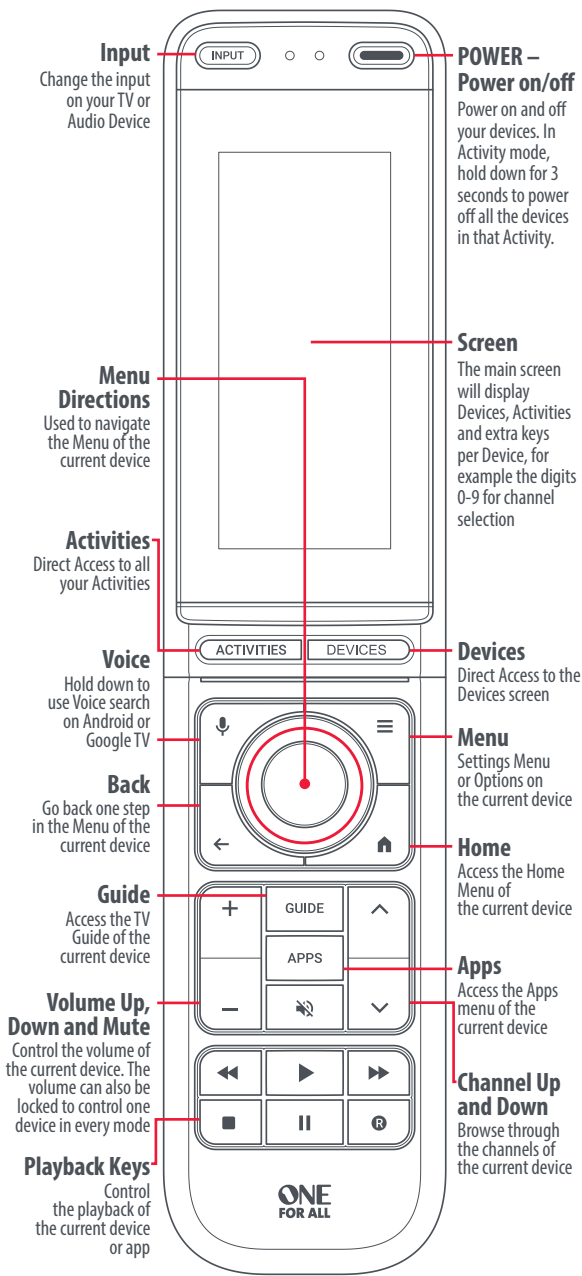

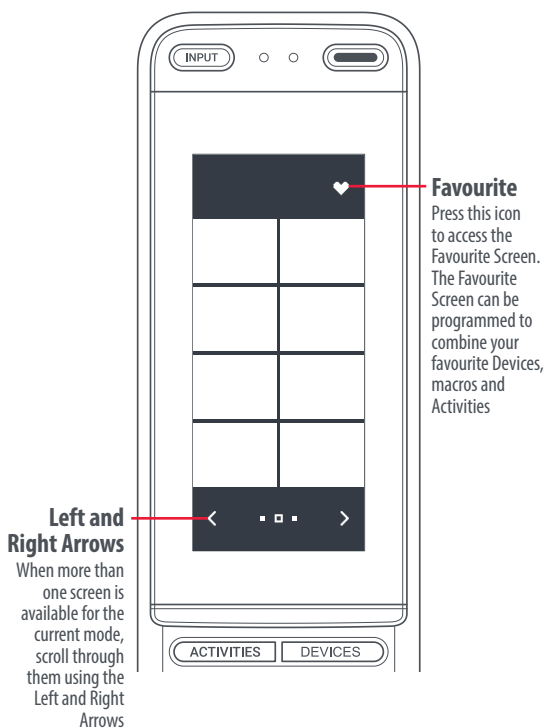

INTRODUCTION

The One For All Smart Control Pro Touch is a Universal Remote Control capable of controlling up to 12 Audio Video devices, including one [Bluetooth controlled device such as a Google TV, Apple TV or Amazon Fire stick.](#)

Once the remote has been set up to control these devices, you will have access to a wealth of useful extra features including [Macros](#), [Activity control](#), [Remote Finder](#) and more. The purpose of this online manual is to help discover those features, how to set them up and to personalise the remote so it's perfectly suited to your home entertainment area.

ONE FOR ALL ADVANCED APP

Programming the remote is done entirely using the One For All Advanced app, so first make sure to download it from the Apple App Store or the Google Play Store by scanning the below code with your phone.

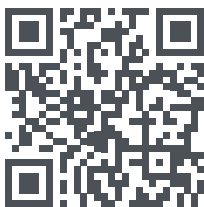

www.oneforall.com/advancedapp

Once downloaded, you will be asked to pair the remote with your phone by holding the Activities and Devices keys down until the LED underneath them blinks. Once it is paired, you should start by setting up your devices.

DEVICE SETUP

The first screen you will see on the app is the Devices screen. This is where you add the devices you want to control using the Smart Pro Touch. It can control up to 12 IR (infrared) controlled devices including TVs, Sound Bars and Set Top Boxes, and one via Bluetooth Low Energy (BLE). A good example of a BLE controlled device would be an Apple TV, a TV running the Google TV Operating System or an Amazon Fire Stick.

Firstly make sure the device you want to set up is turned on, and not in Standby. We recommend you set up your TV first. To set it up first select the device type, then enter the brand. The app will then lead you through a process where you will test a function or two by pointing the remote towards the device and seeing if it reacts.

When you confirm that the functions are working, you will be able to choose the name of the device, for example Samsung TV, and it will be downloaded to the remote. Repeat this for each device you want to control.

DEVICE SETUP

13:57



Set up device

Which device type would you like to set up?

TV

DVD Player

AUDIO / AMP

AV Receiver

TV Box

Streaming / Media Box

SAT/ Cable

Blu-ray Player

Projector

Soundbar

Set up by learning

Next

DEVICE SETUP

13:58



Set up device

Which brand would you like to set up?



Search brand here

Denon

Dune

Funai

Hitachi

HP

Kogan

Laser

LG

Logik

Magnavox

Majestic

Oppo

Next

DEVICE SETUP

13:58



Set up device

Point the remote towards your device
Press Power below
To see if this key works with your Blu-ray Player

Power

Is the button working normally?

SKIP

DEVICE SETUP

14:00



Set up device

Point the remote towards your device
Press Power below
To see if this key works with your Blu-ray Player

Power

Is the button working normally?

YES

NO

SKIP

DEVICE SETUP

14:00



Set up device

Point the remote towards your device
Press Power below
To see if this key works with your Blu-ray Player

Notice



Please ensure your Blu-ray Player is on for upcoming tests.

Blu-ray Player is on

Turn on Blu-ray Player

Is the button working normally?

YES

NO

SKIP

DEVICE SETUP

14:00



Set up device

Point the remote towards your device
Press Menu below
To see if this key works with your Blu-ray Player

Menu

Is the button working normally?

YES

NO

SKIP

DEVICE SETUP

14:01



Set up device

Please name the device

Sony Bluray

Done

DEVICE SETUP

14:01



Set up device

Please name the device

Sony Bluray

Setup Completed



Would you like to set up another device?

No

Yes

Done

DEVICE SETUP

Tip:

If you find that no functions tested worked, or you cannot locate the brand of your devices at all, you can still set it up using the original remote control by selecting “Set up by Learning” at the device type screen. For more information on Learning, check the [Learning](#) section.

Setup by Learning

If the original remote for your devices is working, you can use it to set up a device. When at the device select screen, select “Set up by Learning” and the app will guide you through the process, using the original remote to teach the One For All one key at a time. Some tips to help you through the process:

- Do not learn under a direct incandescent light or in bright sunlight
- Keep the 2 remotes 2 to 5 cm apart and facing each other
- If pressing and releasing a key on the original remote doesn't work, try holding it down for slightly longer
- You can learn onto the physical keys, or create custom keys with their own name and they will be displayed on the screen

DEVICE SETUP

14:01



Set up device

Please name the device

Soundbar

Next

DEVICE SETUP

14:02



Learning



Please select the device and key to program

Remote Keys

Discrete Keys

Extra Keys



Learn Custom Key

Next

DEVICE SETUP

Set up a Bluetooth device

If your device is capable of being controlled by Bluetooth Low Energy (BLE), you can program the Smart Control to use BLE when controlling that device. If you would like to do so the app will lead you through the process of pairing with the device.

This can differ per device; here we show an Apple TV. This can be controlled via IR as well, so when you first set it up you will test some functions and it will be added to the Device screen. From here you can click the icon with the 3 dots and choose the option Pair with Bluetooth Device.

For Bluetooth only devices such as an Amazon Fire TV stick, the app will prompt you to pair the device automatically.

DEVICE SETUP

10:45



OFA Advanced



Samsung TV



Apple TV



Sony Bluray



Onkyo AVR



Add a new device

Edit Device

Rename Device

Pair with Bluetooth Device

Delete Device

Cancel

DEVICE SETUP

14:14



OFA Advanced

Please follow the pairing guide below to pair your Bluetooth remote with Apple TV

1.

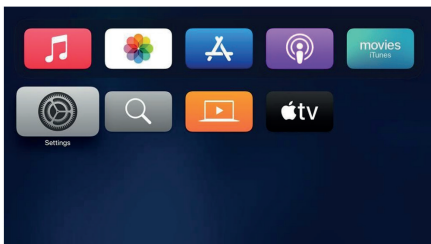

Go to Settings

2.

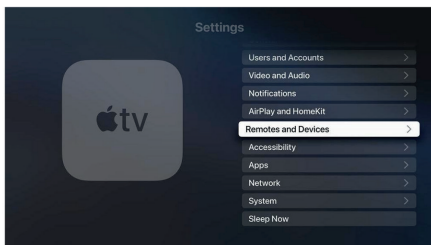

Select "Remotes and Devices"

3.

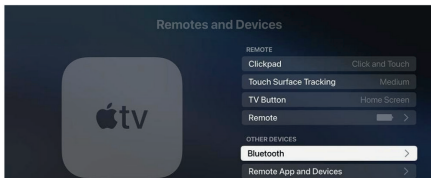

Done

DEVICE SETUP

Follow the on screen instructions in the app and when prompted on the OFA remote select the device from the touch screen and the remote will enter pairing mode - the LEDs will flash blue. Follow the instructions on the device to pair the remote, and the LEDs will blink green twice to confirm success. The Smart Control Pro Touch is now paired with the device.

If you wish to carry on programming the remote, you will need to briefly hold Activities and Devices on the OFA remote to swap the pairing back to your phone.

When your device has successfully been paired with the remote via Bluetooth, you will see a green icon under the device in the Devices screen. If it is not paired you will see a red exclamation mark.

DEVICE SETUP

14:15



OFA Advanced



Samsung TV



Apple TV



Add a new device



Devices



Activities



Favourite



Features

DEVICE SETUP

14:14



OFA Advanced



Samsung TV



Apple TV



Add a new device



DEVICE SETUP

Bluetooth Control

If the device paired is a Google or Android TV device, you will also be able to use voice control using the voice (microphone) key.

When you select the device from the Devices or Activities screens on the remote, it will automatically connect and you will see 2 green blinks. When you change the device or activity you are controlling, the connection will be dropped until the next time you select the device.

Note that the OFA Remote can only be paired with one AV Device using Bluetooth, so if you have multiple you should choose the device you use most.

ACTIVITIES

Activities

An Activity is a combination of multiple devices into a single mode. For example, when you are watching a show on your Set Top Box, you are also controlling the input of your television and the volume of your Sound Bar. You can combine this into an Activity called for example Watch TV.

In the Activity mode, you can assign groups of keys to different devices. The groups are the input key, the keys displayed on the screen, the keys except for the Volume controls, and the Volume Up, Down and Left. So when you select this Activity on the remote, you can control the relevant functions for the relevant device without having to swap devices.

ACTIVITIES

14:23



OFA Advanced



Add a new activity



Devices



Activities



Favourite



Features

ACTIVITIES

14:25



Set Up Activity

Please select combination for Watch Bluray Activity

Samsung TV ▾



Sony Bluray ▾

LG Soundbar ▾

Sony Bluray ▾

Save

ACTIVITIES

To set up an Activity, firstly ensure that you have already set up the OFA remote to control all the devices you wish to control. Next select the Activities screen in the app, and tap “Add a new activity”. You can now name the Activity and select which key groups can control which devices. This will then be downloaded to your remote and added to the Activities screen on the remote.

Select the activity by clicking on the name, and the keys will now behave as you have programmed.

As the activity is a combination of devices, the power key behaves slightly differently. Holding down the Power key for 2 seconds will send Power to all the devices contained within the Activity.

We recommend you use this when you have finished using the activity, for example you have finished watching TV for the evening, just hold down the Power key and turn everything off.

You can also add a macro to an Activity, which can turn on devices and select input when you choose the Activity from the screen of the remote. For more information, see the section [“Macros”](#).

ACTIVITIES

14:25



OFA Advanced



Stream TV

Combination: Samsung TV + Apple TV + LG Soundbar



Watch Bluray

Combination: Samsung TV + Sony Bluray + LG Soundbar



Add a new activity



Devices



Activities



Favourite



Features

FAVOURITE

Favourite Screen

The Favourite Screen is a custom screen on the remote where you can add your favourite [devices](#), [activities](#), [macros](#) and keys. By default it is blank, but once you have set up some devices, activities or macros, you can easily add them to the screen.

FAVOURITE

14:25



OFA Advanced





Devices



Activities



Favourite



Features

FAVOURITE

14:26



OFA Advanced



Samsung TV

**Watch
Bluray**



Devices



Activities



Favourite



Features

FAVOURITE

To assign Favourites, simply go to the Favourite page in the app, and select a blank square to fill.

If you select a macro or a function, you will be able assign a device or activity that the remote will end up in after sending that macro or function, for instance sending a 3 digit channel number and then controlling your Set Top Box. This can be set up by tapping the “Switch To” link at the bottom of the screen.

FAVOURITE

10:48



Favourite

Please select the device and key for favourite

Remote Keys

Discrete Keys

Extra Keys

Samsung TV



Search key here

TV

HDMI1

HDMI2

HDMI3

HDMI4

Power On



Switch to



Next

FAVOURITE

10:48



Favourite

Do you need to change to specific mode after key emitted?

Devices

Activities



Samsung TV



Apple TV



Sony Bluray



Onkyo AVR

Delete

Save

FAVOURITE

When using the remote, the Favourite screen can be accessed from any screen by pressing the heart icon on the top right of the screen. As well as your Favourites, the screen also give access to the on-remote settings, by selecting the settings icon on the top right. For more on this, see the section [Remote Settings](#).

FEATURES

Learning

The Smart Control Pro Touch is capable of learning keys from original infrared remote controls. You can choose to learn a function or two, or learn an entire remote control. This can be useful if the standard [Device Setup](#) doesn't work. Learning is initiated by the app, but to prepare make sure you have the original working remote to hand as well the Smart Control.

The app will guide you through the procedure, but basically it involves pointing the original remote towards the OFA remote, selecting a destination key on the app, and then pressing the desired key on the original remote. You can learn onto a key on the remote or select Learn Custom key, and you will be able to name that key and it will appear on the screen of the remote under the device you selected.

FEATURES

14:26



Learning



Please select the device and key to program

Remote Keys

Discrete Keys

Extra Keys

Samsung TV

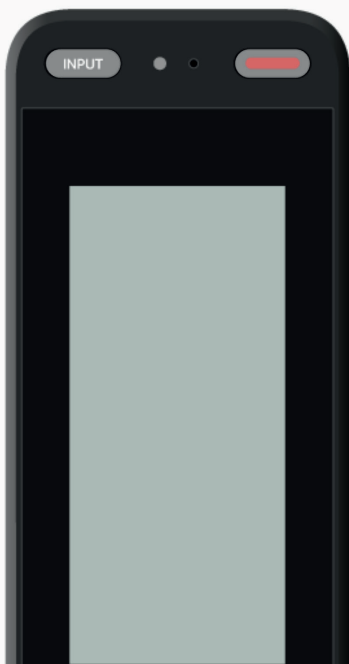

Learn Custom Key

Next

FEATURES

14:27



Delete Learning

Please select the device and key to delete

Remote Keys

Discrete Keys

Extra Keys

Samsung TV



FEATURES

It is possible to delete learned functions also by selecting the trash can icon on the top right. Some tips for learning are:

- Do not learn under a direct incandescent light or in bright sunlight
- Keep the 2 remotes 2 to 5 cm apart and facing each other
- If pressing and releasing a key on the original remote doesn't work, try holding it down for slightly longer

FEATURES

Macros

A macro is a series of key presses assigned to a single key. For example a 3 digit channel number could be programmed onto one key for easy access. Even more usefully, macros can be assigned to [Activities](#), so that when the Activity is selected, the remote can turn on the relevant devices and select any relevant inputs. An example would be creating a macro for a Watch TV Activity which turns on the TV, STB and Sound Bar, then waits 5 seconds and selects HDMI 1 on the TV, and then enters the Watch TV mode, ready to control the Activity.

To program a macro, select Macro from the Features Page of the app. Then you will be asked to select either a key on the remote or an Activity. You will then see a brief explanation of how to build a macro.

FEATURES

14:31



Macro



Please select the macro key

Devices

Activities



Next

FEATURES

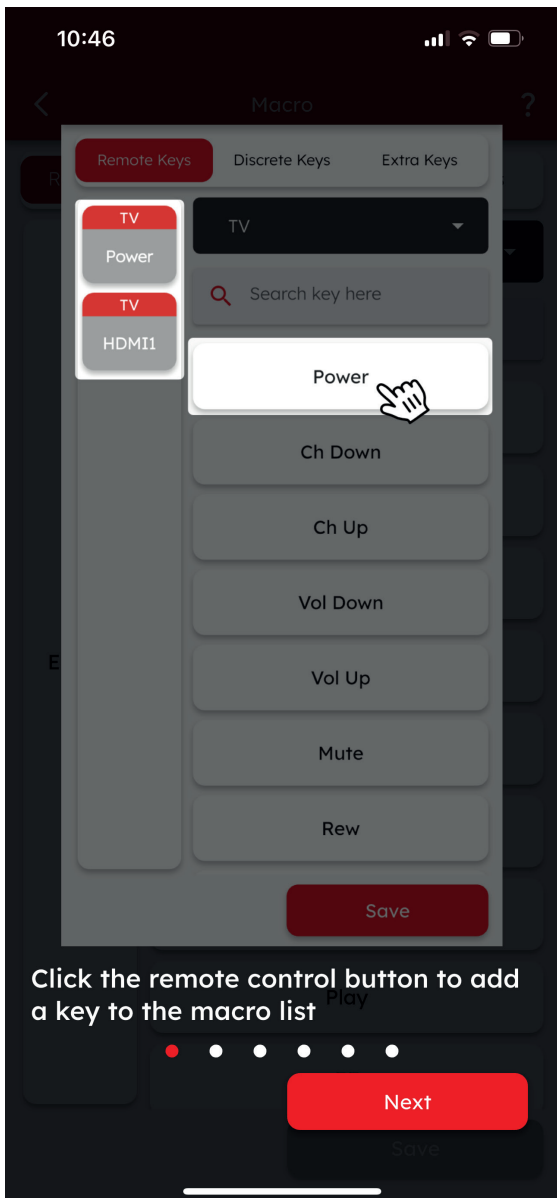

FEATURES

You can build a list of keys on the left of the screen by selecting the device and then the key on right hand side. You will notice that there are 3 types of keys.

Remote Keys

Remote Keys are the physical keys on the Smart Control, as well as those shown on the screen.

Discrete Keys

Discrete Keys are keys that perform a direct function, which may not be available on your original remote, but come in very useful when building a macro. For example, the Power key on your original remote turns the TV On and Off. But for some major manufacturers, there are discrete keys for Power On and Power Off. These will only turn the TV on or off respectively, and not toggle between the two. So no matter how many times you send the Power On function, the TV will never turn off, unlike the standard Power button.

Similarly using the original remote, pressing the Input key will normally bring up a menu where you can choose which HDMI Input you want to select. But some brands of TV support discrete keys for HDMI 1, HDMI 2 etc. These are also useful in a macro as you can be sure which input you are selecting and therefore which device's picture will be shown.

FEATURES

14:32



Macro



Remote Keys

Discrete Keys

Extra Keys

Samsung TV



Search key here

Power

Ch Down

Ch Up

Vol Down

Vol Up

Mute

Rew

Play

FF

Empty

Save

FEATURES

14:32



Macro



Remote Keys

Discrete Keys

Extra Keys

Samsung
TV

Samsung TV



Power On



Search key here

TV

HDMI1

HDMI2

HDMI3

HDMI4

Power On

Power Off

Save

FEATURES

It is important to note that not all manufacturers support discrete keys, so they may not be available for your specific device.

Extra Keys

Extra keys are keys that may have been on your original remote, but are not featured on the standard keys of the OFA Remote. Examples of these would be Subtitles or Settings Menu.

Once a key has been added to the list on the left, tapping on it will give some extra options. You can set a delay before the next key in the list is sent. This is useful if you need wait for a few seconds – for example if you turn a TV on, it will generally take a few seconds before it can respond to another command such as selecting HDMI Input. You can also set an amount of time a key is held down for.

All of these options combine to give you the opportunity to create smart macros for starting an [Activity](#). For example if you have created a Watch TV Activity that combines control of your TV, Set Top Box and Sound Bar, you could program a macro onto it that would turn on your TV, turn on your Set Top Box, turn on your Sound Bar, wait for 5 seconds and then select HDMI 1 on the TV. The devices would then be in the correct state, and the remote would be in the Watch TV mode combining control of them.

And remember an Activity has an automatic Power Off macro when you hold down the Power key for 2 seconds in the Activity mode.

FEATURES

14:33



Macro



Remote Keys

Discrete Keys

Extra Keys

Samsung
TV

Power On

Apple TV

Power On

LG
Soundbar

Power On

LG Soundbar



Search key here

TV

Optical

Power On

Power Off

Set Delay Time

Set Press & Hold Time

Delete Key

Cancel

FEATURES

14:33



Macro



Remote Keys

Discrete Keys

Extra Keys

Samsung
TV

Power On

Apple TV

Power On

LG Soundbar



Search key here

TV

Set Delay Time



5.0s



4

5

0

6

1

Cancel

OK

Save

FEATURES

Key Mover

The Key Mover feature allows you to copy the functionality of a key within a particular device to a different key in any device. This includes [Remote Keys](#), [Discrete Keys](#) and [Extra Keys](#).

FEATURES

14:34



Key Mover



Please select the device and key to program

Samsung TV



Next

FEATURES

14:35



Key Mover

Please select the device and key to send

Remote Keys

Discrete Keys

Extra Keys

Samsung TV



Search key here

Power

Ch Down

Ch Up

Vol Down

Vol Up

Mute

Rew

Save

FEATURES

Volume Lock

The Volume Lock feature allows you to lock the Volume Up, Down and Mute keys so that they always control one particular device no matter which device mode you are in. So if you use a Sound Bar, for example, you will want to control the volume of that always without having to switch to the Sound Bar device.

Note that Volume Lock is not applicable for [Activities](#), which can have a dedicated volume control per Activity.

FEATURES

14:37



Volume Lock

Please select the volume lock channel



Samsung TV



Apple TV



Sony Bluray



LG Soundbar

FEATURES

14:37



Volume Lock

Please select the volume lock channel

Volume Lock



If you always use one device to control volume, for example your TV or an AV Receiver, you can set up the Smart Controls to always address that device, regardless of which device your remote is controlling.

Would you like to enable the volume lock?

Cancel

Enable

FEATURES

Edit Extra Keys

The Edit Extra Keys feature allows you to add keys to the screen for each device. Once you have selected the device, you will see a list of functions which are available for your device that do not currently have a key on the Smart Control. Selecting the keys will add them to keys shown on the screen in the device mode.

FEATURES

14:50



Edit Extra Key

Discrete Keys

Extra Keys

page 1



Search key here

Teletext
ON

Samsung
TV+

FAV

Prev

Next

Teletext ON

DVRLIST

Samsung TV+

Option

CH Enter

Setup

Smart TV

Delete

Next

FEATURES

14:50



Preview



Save

FEATURES

Remote Settings

The Remote Settings screen is a mirror of the settings which are also accessible on the remote itself, from the Favourite screen. The settings are:

Touch screen

Here you can adjust the brightness of the screen backlight, along with its duration. The brightness options are Off, Low, Medium and High. The Timeout options are 5s, 10s, 15s, 30s and 60s.

Keypad Backlight

Here you can adjust the brightness of the keypad backlight, along with its duration. The brightness options are Off, Low, Medium and High. The Timeout options are 5s, 10s, 15s, 30s and 60s.

Sensor

The Smart Control features an Ambient Light Sensor to dim the backlight when the room is well lit, and a motion sensor to activate the screen when the remote is picked u.

Light

In the section the user can set the light sensor to off, low, medium or high.

Motion

The motion sensor can be turned on or off.

FEATURES

Touchscreen

To save battery, the touch screen is deactivated after a number of seconds. Here you can adjust the timeout for this. Timeout options are 5s, 10s, 15s, 30s and 60s.

Sound

In this section the you can adjust the settings of the sound made when a key is pressed.

Mode

You can choose between hearing the beep on the screen keys only, the hard keys only or both.

Level

Here you can choose one of 5 volume settings, with 1 being lowest and 5 highest.

Key Display Type

For certain streaming apps such as Netflix, there are custom icons available. Here you can choose between showing these icons or displaying the name in text.

FEATURES

14:50



Remote Settings

Touchscreen

Timeout

5s >

Screen Backlit

Brightness

Low >

Timeout

5s >

Keypad Backlit

Brightness

Low >

Timeout

5s >

Sensor

Light

Off >

Motion

On >

Sound

Mode

Screen key only >

Level

3 >

Key Display Type

Type

Text >

FEATURES

14:50



Key Display Type

Please select the display type for the APP keys showed on remote

Text

Logo

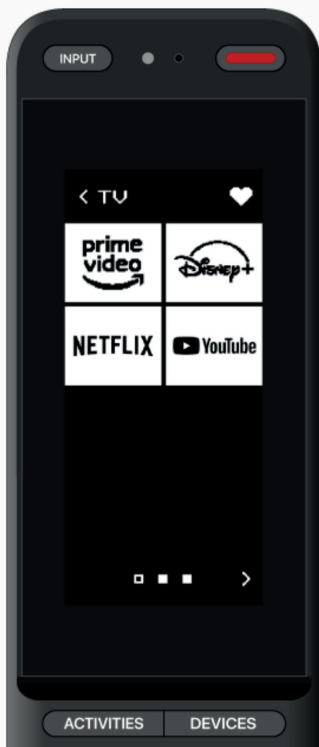

Save

FEATURES

Remote Finder

The Smart Control Pro Touch has a useful feature in case you can't find it. Simply press the bell on the top left of the [Devices](#), [Activities](#) or [Favourite](#) screens and the remote will beep to allow you to locate it.

FEATURES

14:51



OFA Advanced



Learning



Macro



Key Mover



Find My Remote



Your remote has been located!
Please follow the beeping sound to
find your remote.

Cancel



Devices



Activities



Favourite



Features

FEATURES

App Settings

Also accessible from the [Devices](#), [Activities](#) and [Favourite](#) screen, pressing the cog icon on the top right will display a screen detailing the setting of the app.

The screen shown is an example.

FEATURES

14:51



Settings

App Version	1.0.2
-------------	-------

Remote Model	URC7985 R00
--------------	-------------

Remote Firmware Version	0.2.11
-------------------------	--------

e-Paper Firmware Version	0.1.25
--------------------------	--------

Battery Level	88%
---------------	-----

Language	English >
----------	-----------

Switch Remotes	>
----------------	---

Factory Reset	>
---------------	---